

EUROCRAFT INDUSTRIES INC.

76AD FIXED WINDOW (IMPACT) (HVHZ)

GENERAL NOTES:

- THE PRODUCT SHOWN HEREIN IS DESIGNED AND MANUFACTURED TO COMPLY WITH THE CURRENT EDITION FLORIDA BUILDING CODE (FBC), INCLUDING HVHZ AND HAS BEEN EVALUATED ACCORDING TO THE FOLLOWING:
 - TAS 201-94
 - TAS 202-94
 - TAS 203-94
- ADEQUACY OF THE EXISTING STRUCTURAL CONCRETE/MASONRY, 2X FRAMING, AND METAL FRAMING AS A MAIN WIND FORCE RESISTING SYSTEM CAPABLE OF WITHSTANDING AND TRANSFERRING APPLIED PRODUCT LOADS TO THE FOUNDATION IS THE RESPONSIBILITY OF THE ENGINEER OR ARCHITECT OF RECORD FOR THE PROJECT OF INSTALLATION.
- 1X AND 2X BUCKS (WHEN USED) SHALL BE DESIGNED AND ANCHORED TO PROPERLY TRANSFER ALL LOADS TO THE STRUCTURE. BUCK DESIGN AND INSTALLATION IS THE RESPONSIBILITY OF THE ENGINEER OR ARCHITECT OF RECORD FOR THE PROJECT OF INSTALLATION.
- INSTALL INDIVIDUAL INSTALLATION ANCHORS WITHIN A TOLERANCE OF ±1/4 INCH OF THE DEPICTED LOCATION IN THE ANCHOR LAYOUT DETAIL (I.E., WITHOUT CONSIDERATION OF TOLERANCES). TOLERANCES ARE NOT CUMULATIVE FROM ONE INSTALLATION ANCHOR TO THE NEXT.
- THE INSTALLATION DETAILS DESCRIBED HEREIN ARE GENERIC AND MAY NOT REFLECT ACTUAL CONDITIONS FOR A SPECIFIC SITE. IF SITE CONDITIONS CAUSE INSTALLATION TO DEVIATE FROM THE REQUIREMENTS DETAILED HEREIN, A LICENSED ENGINEER OR ARCHITECT SHALL PREPARE SITE SPECIFIC DOCUMENTS FOR USE WITH THIS DOCUMENT IN NON-HVHZ AREAS. IN HVHZ AREAS, ONE TIME PRODUCT APPROVAL TO BE OBTAINED FROM MIAMI-DADE RER OR AHJ.
- APPROVED IMPACT PROTECTIVE SYSTEM **IS NOT REQUIRED** ON THIS PRODUCT IN AREAS REQUIRING IMPACT RESISTANCE.
- WINDOW FRAME MATERIAL: RIGID PVC
- GLASS MEETS THE REQUIREMENTS OF ASTM E 1300 GLASS CHARTS. SEE SHEET 1 FOR GLAZING DETAILS.

TYP. OVERALL SIZE		DESIGN PRESSURE	CONFIGURATION	GLAZING	IMPACT RATING
WIDTH	HEIGHT				
48"	120"	+/- 120 PSF	"O"	G1-G4	LMI
96 ⁷ / ₈ "	120"	+/- 75 PSF	"OO"	G1-G4	LMI

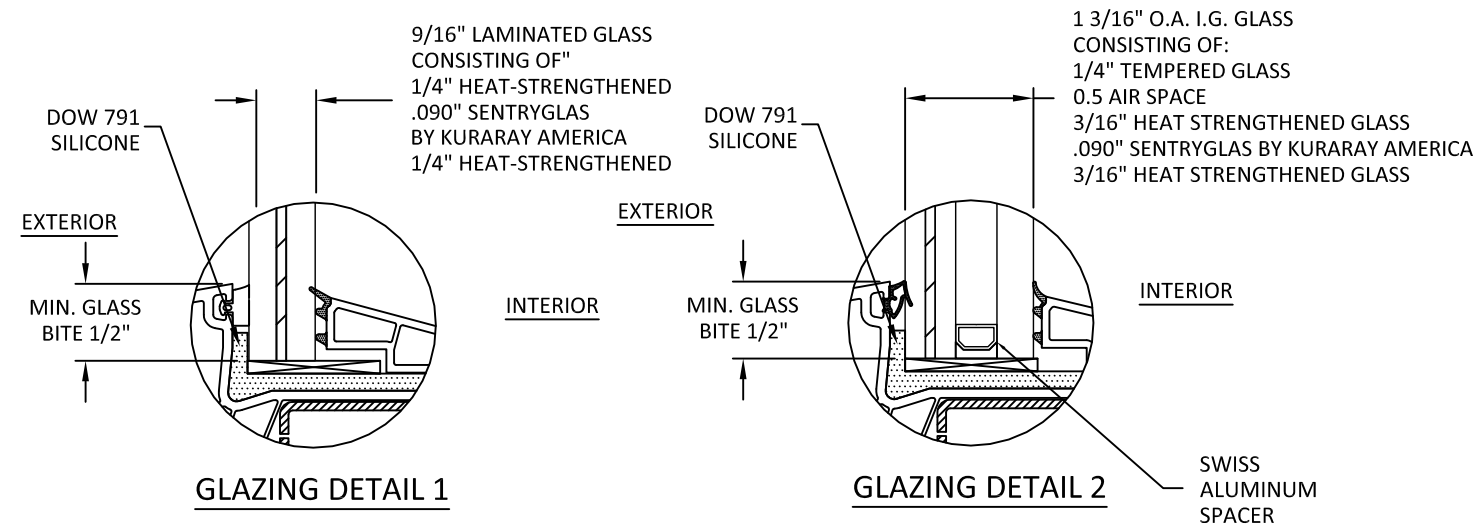

NOTE:

- GLASS TYPE AND THICKNESS COMPLY WITH ASTM E-1300 GLASS CHART REQUIREMENTS.
- ALL GLAZING CONFIGURATIONS COMPLY WITH SAFETY GLAZING REQUIREMENTS OUTLINED IN CURRENT FBC
- SETTING BLOCK SHALL BE 70-90 DUROMETER AS PER CH 24 OF THE CURRENT FBC.
- GLASS LITES THAT EXCEED 36" IN WIDTH SHALL USE SETTING BLOCKS AT 1/4 SPAN FROM CORNERS.

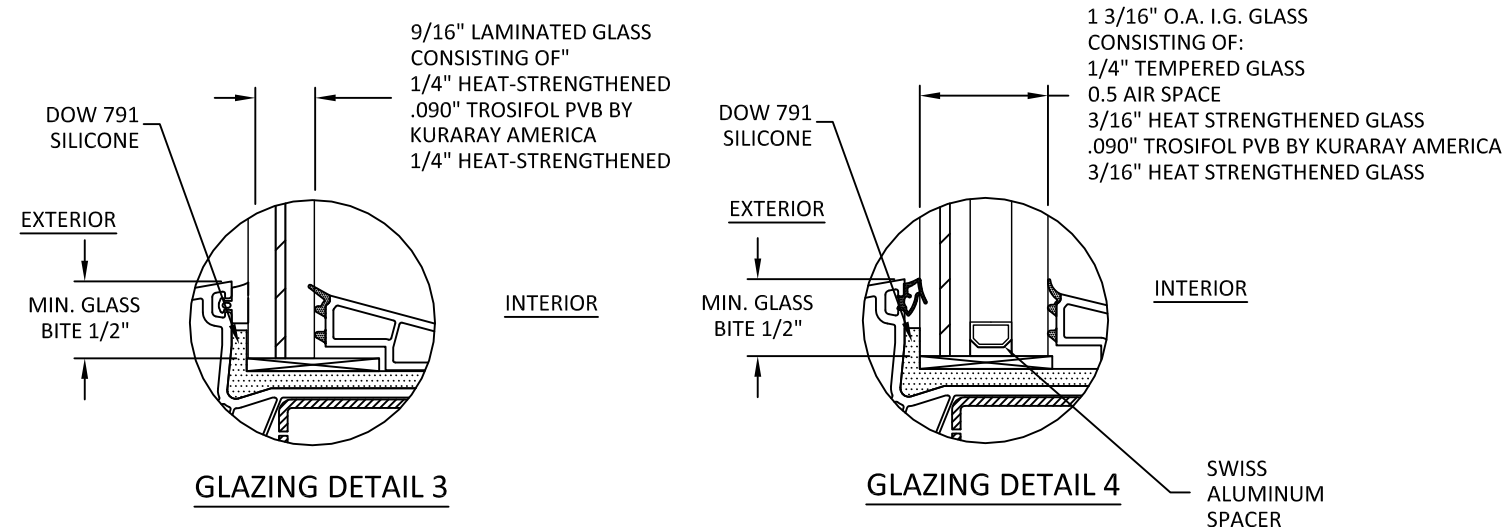

TABLE OF CONTENTS

SHEET	REVISION	SHEET DESCRIPTION
1	-	GENERAL NOTES AND GLAZING DETAILS
2	-	ELEVATIONS & ANCHOR LAYOUTS
3	-	ELEVATIONS & ANCHOR LAYOUTS
4	-	VERTICAL SECTIONS
5	-	HORIZONTAL SECTIONS
6	-	INSTALLATION NOTES & ANCHOR DETAILS
7	-	COMPONENT & BILL OF MATERIALS



7905 NW 77TH AVE
MEDLEY, FL 33166
PH: (305) 888-5718 FX: (305) 220-5073

TITLE: 76AD FIXED WINDOW (IMPACT) (HVHZ)
GENERAL NOTES & GLAZING DETAILS
PREPARED BY: BUILDING DROPS, INC.
398 E. DANIA BEACH BLVD., STE. 338
DANIA BEACH, FL 33004
PH: (954) 399-8478
FAX: (954) 744-4738
WEB: www.buildingdrops.com

REMARKS	BY	DATE

THE INSTALLATION DETAILS DESCRIBED HEREIN ARE GENERIC AND MAY NOT REFLECT ACTUAL CONDITIONS FOR A SPECIFIC SITE. IF SITE CONDITIONS CAUSE INSTALLATION TO DEVIATE FROM THE REQUIREMENTS DETAILED HEREIN, A LICENSED ENGINEER OR ARCHITECT SHALL PREPARE SITE SPECIFIC DOCUMENTS FOR USE WITH THIS DOCUMENT



FL #: **FL27614**
DATE: **04.19.19**
DWG. BY: **EG** CHK. BY: **HFN**
SCALE: **NTS**
DWG. #: **ECI012**
SHEET: **1** OF 7

6/21/2019 5:24 PM

s:\projects\eurocraft\industries\inc\fbc-19-0320 - fbc submittal - fl2092, fl27614, fl27615 - revision\dwg\fixed\ec1012 - fx.dwg

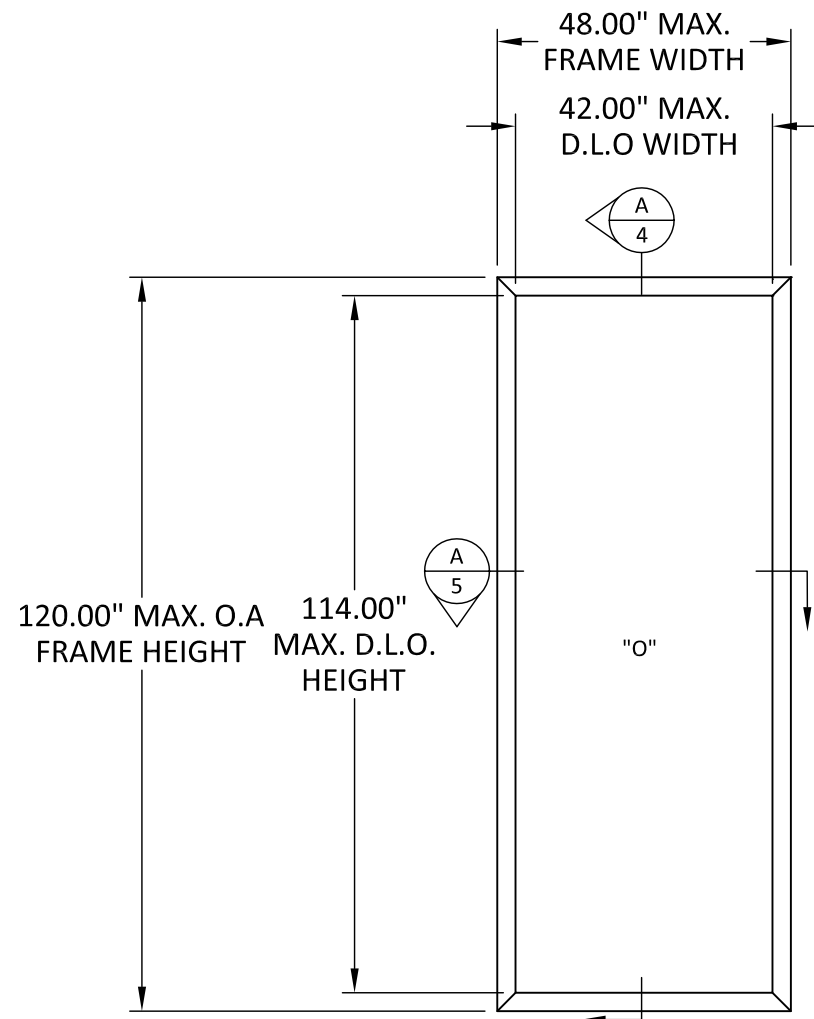

ELEVATION
FIXED WINDOW - SINGLE

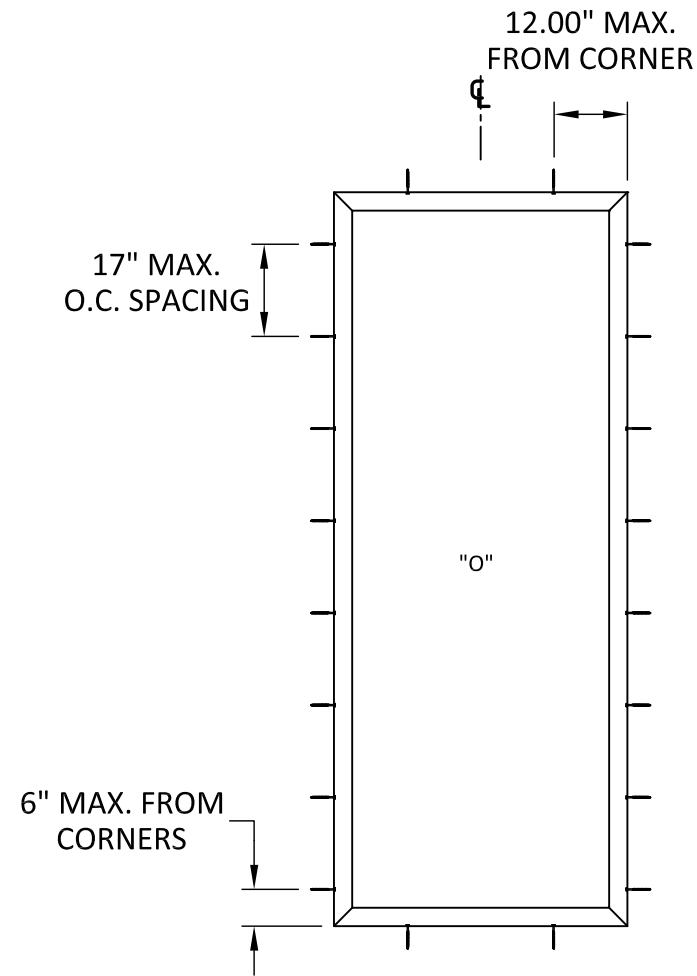

ANCHOR LAYOUT
FIXED WINDOW - SINGLE
THROUGH FRAME

DESIGN PRESSURE TABLE (psf) - FIXED WINDOW

		PANEL WIDTH (INCHES)										
		24	30	36	42	48	54	60	66	72	78	84
PANEL HEIGHT (INCHES)	60	120.0	120.0	120.0	120.0	120.0	106.7	96.0	105.6	109.7	96.0	85.3
	66	120.0	120.0	120.0	120.0	120.0	106.7	96.0	87.3	95.2	102.4	90.4
	72	120.0	120.0	120.0	120.0	120.0	106.7	96.0	87.3	80.0	86.7	-
	78	120.0	120.0	120.0	120.0	120.0	106.7	96.0	87.3	80.0	-	-
	84	120.0	120.0	120.0	120.0	120.0	106.7	96.0	87.3	80.0	-	-
	90	120.0	120.0	120.0	120.0	120.0	106.7	96.0	-	-	-	-
	96	120.0	120.0	120.0	120.0	120.0	106.7	96.0	-	-	-	-
	102	120.0	120.0	120.0	120.0	120.0	106.7	-	-	-	-	-
	108	120.0	120.0	120.0	120.0	120.0	-	-	-	-	-	-
	114	120.0	120.0	120.0	120.0	120.0	-	-	-	-	-	-
120	120.0	120.0	120.0	120.0	120.0	-	-	-	-	-	-	

QUALIFIED CONFIGURATIONS

NOTE:
CONFIGURATIONS WITH
CASEMENT/TILT & TURN QUALIFIED
UNDER SEPERATE APPROVAL.

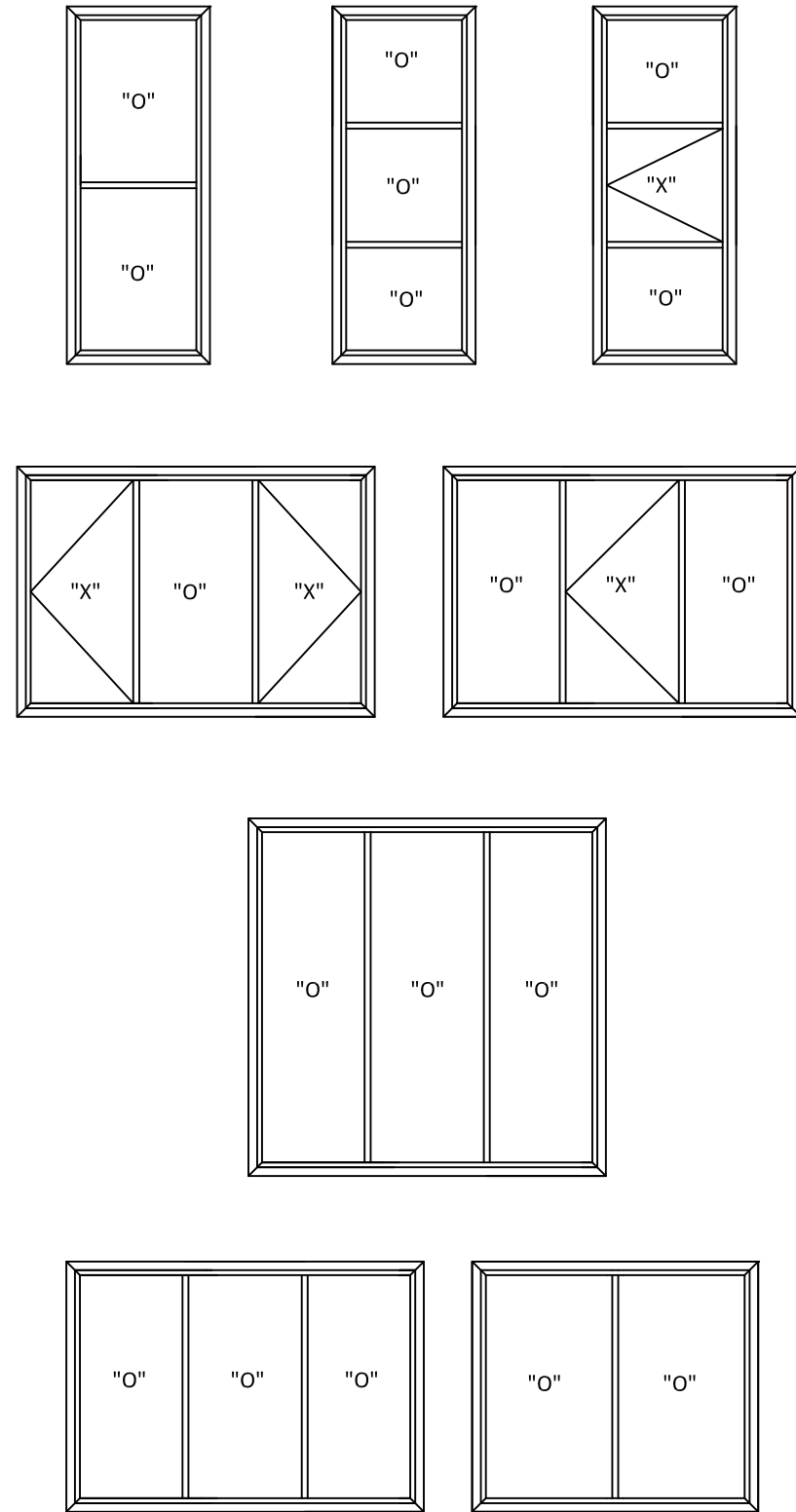

7905 NW 77TH AVE
MEDLEY, FL 33166
PH: (305) 888-5718 FX: (305) 220-5073

TITLE: 76AD FIXED WINDOW (IMPACT) (HVHZ)
ELEVATIONS AND ANCHOR LAYOUTS
PREPARED BY: BUILDING DROPS, INC.
398 E. DANIA BEACH BLVD., STE. 338
DANIA BEACH, FL 33004
PH: (954)399-8478
FAX: (954)744-4738
WEB: www.buildingdrops.com

REMARKS	BY	DATE

THE INSTALLATION DETAILS DESCRIBED HEREIN ARE GENERIC AND MAY NOT REFLECT ACTUAL CONDITIONS FOR A SPECIFIC SITE. IF SITE CONDITIONS CAUSE INSTALLATION TO DEVIATE FROM THE REQUIREMENTS DETAILED HEREIN, A LICENSED ENGINEER OR ARCHITECT SHALL PREPARE SITE SPECIFIC DOCUMENTS FOR USE WITH THIS DOCUMENT.

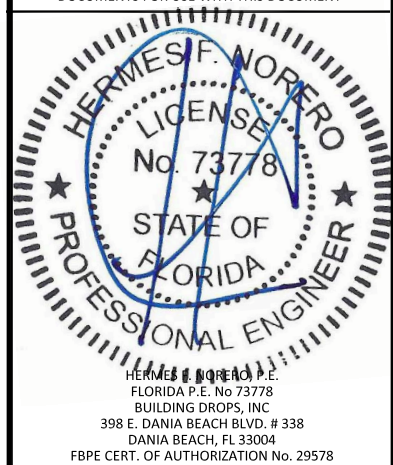

FL #: **FL27614**
DATE: **04.19.19**
DWG. BY: **EG** CHK. BY: **HFN**
SCALE: **NTS**
DWG. #: **ECI012**
SHEET: **2**
OF 7



7905 NW 77TH AVE
MEDLEY, FL 33166
PH: (305) 888-5718 FX: (305) 220-5073

TITLE: 76AD FIXED WINDOW (IMPACT) (HVHZ)
ELEVATIONS AND ANCHOR LAYOUTS

PREPARED BY: BUILDING DROPS, INC.
398 E. DANIA BEACH BLVD., STE. 338
DANIA BEACH, FL 33004
PH: (954) 399-8478
FAX: (954) 744-4738
WEB: www.buildingdrops.com

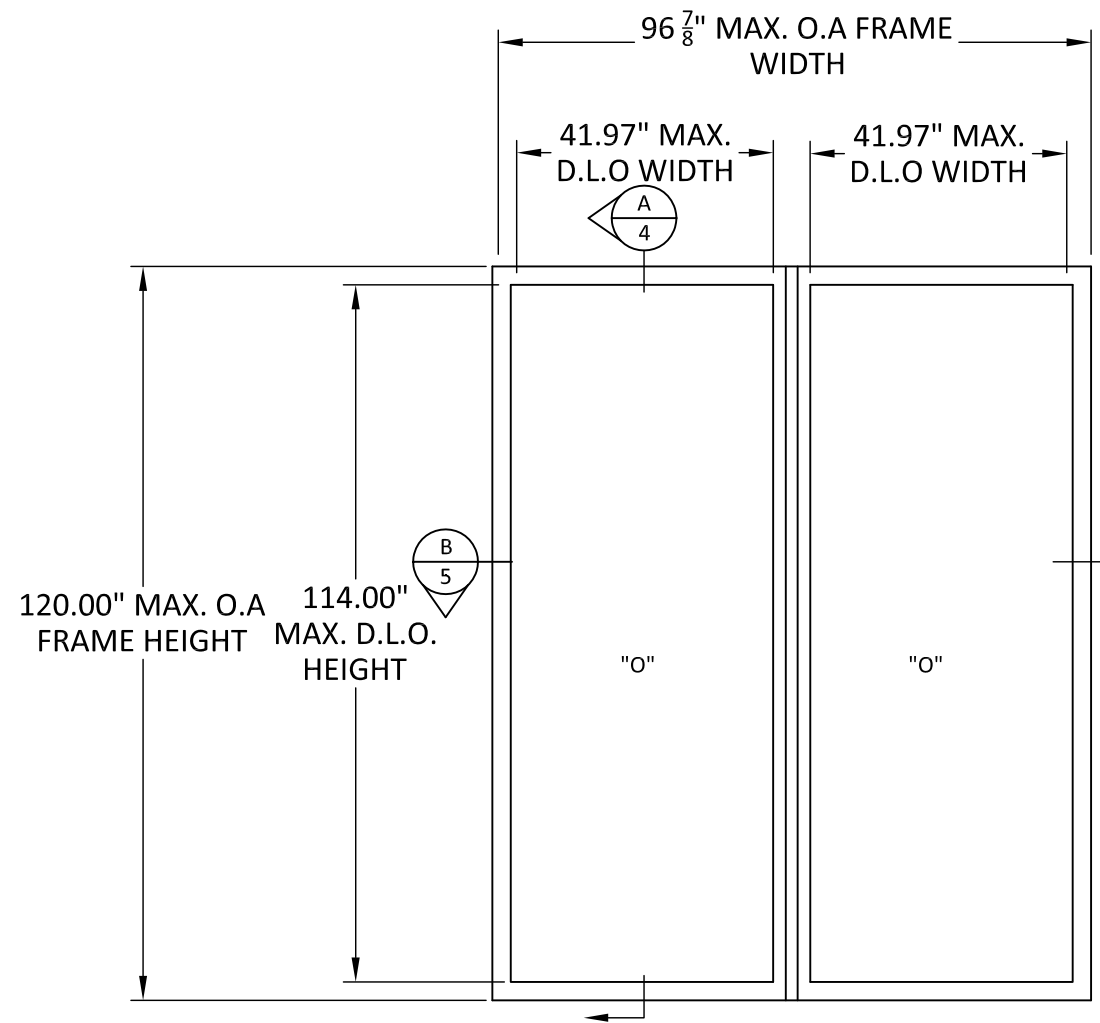

ELEVATION
FIXED WINDOW - TWIN

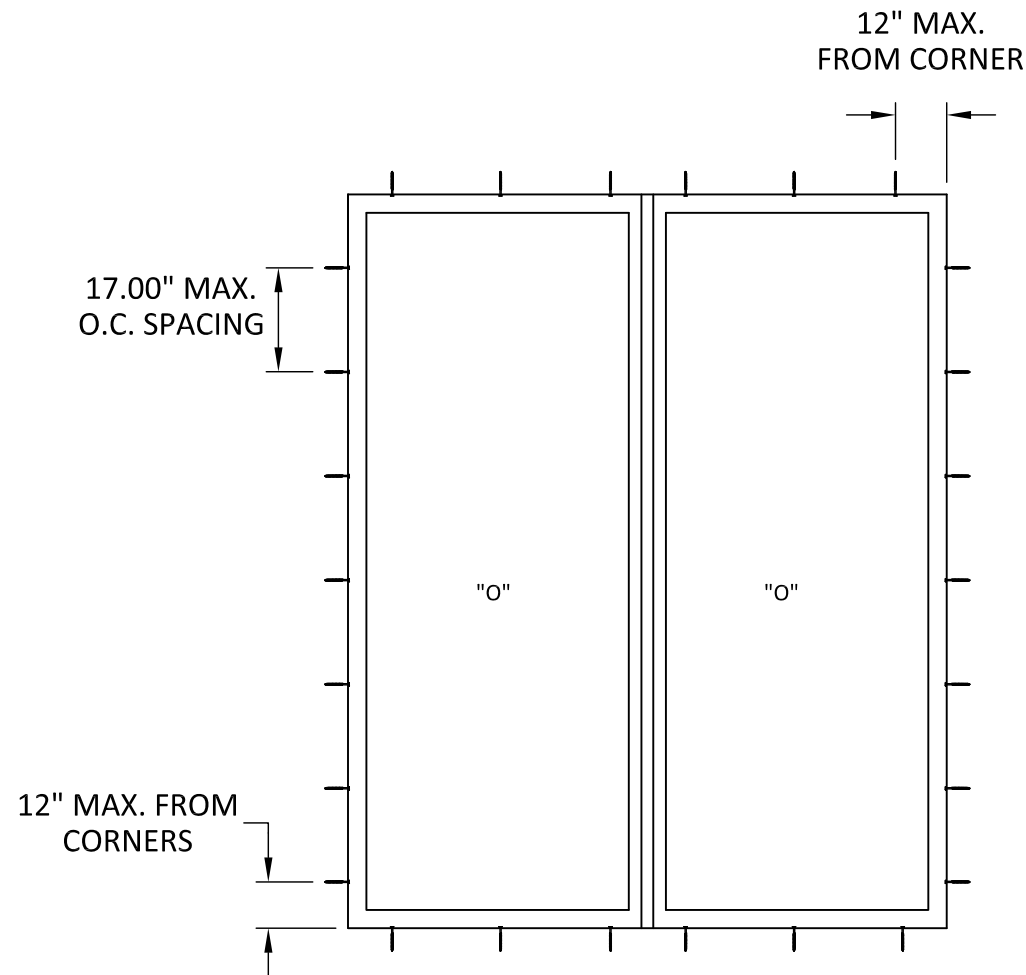

ANCHOR LAYOUT
FIXED WINDOW - TWIN
THROUGH FRAME

REMARKS	BY	DATE

THE INSTALLATION DETAILS DESCRIBED HEREIN ARE GENERIC AND MAY NOT REFLECT ACTUAL CONDITIONS FOR A SPECIFIC SITE. IF SITE CONDITIONS CAUSE INSTALLATION TO DEVIATE FROM THE REQUIREMENTS DETAILED HEREIN, A LICENSED ENGINEER OR ARCHITECT SHALL PREPARE SITE SPECIFIC DOCUMENTS FOR USE WITH THIS DOCUMENT.



FL #: **FL27614**

DATE: **04.19.19**

DWG. BY: **EG** CHK. BY: **HFN**

SCALE: **NTS**

DWG. #: **ECI012**

SHEET:

DESIGN PRESSURE TABLE (psf) - FIXED WINDOW (TWIN)												
		PANEL WIDTH (INCHES)										
		24	30	36	42	48	54	60	66	72	78	84
PANEL HEIGHT (INCHES)	60	75.0	75.0	75.0	75.0	75.0	66.7	60.0	66.0	68.6	60.0	53.3
	66	75.0	75.0	75.0	75.0	75.0	66.7	60.0	54.5	59.5	64.0	56.5
	72	75.0	75.0	75.0	75.0	75.0	66.7	60.0	54.5	50.0	54.2	-
	78	75.0	75.0	75.0	75.0	75.0	66.7	60.0	54.5	50.0	-	-
	84	75.0	75.0	75.0	75.0	75.0	66.7	60.0	54.5	-	-	-
	90	75.0	75.0	75.0	75.0	75.0	66.7	60.0	-	-	-	-
	96	75.0	75.0	75.0	75.0	75.0	66.7	60.0	-	-	-	-
	102	75.0	75.0	75.0	75.0	75.0	66.7	-	-	-	-	-
	108	75.0	75.0	75.0	75.0	75.0	-	-	-	-	-	-
	114	75.0	75.0	75.0	75.0	75.0	-	-	-	-	-	-
120	75.0	75.0	75.0	75.0	75.0	-	-	-	-	-	-	

6/21/2019 5:24 PM s:\projects\eurowcraft\industries\inc\lbc-19-0320 - fbc submittal - fl2092, fl27614, fl27615 - revision\dwg\fixed\ec012 - fx.dwg



7905 NW 77TH AVE
MEDLEY, FL 33166
PH: (305) 888-5718 FX: (305) 220-5073

TITLE: 76AD FIXED WINDOW (IMPACT) (HVHZ) VERTICAL SECTIONS

PREPARED BY:  BUILDING DROPS, INC.
398 E. DANIA BEACH BLVD., STE. 338
DANIA BEACH, FL 33004
PH: (954)399-8478
FAX: (954)744-4738
WEB: www.buildingdrops.com

REMARKS	BY	DATE

THE INSTALLATION DETAILS DESCRIBED HEREIN ARE GENERIC AND MAY NOT REFLECT ACTUAL CONDITIONS FOR A SPECIFIC SITE. IF SITE CONDITIONS CAUSE INSTALLATION TO DEVIATE FROM THE REQUIREMENTS DETAILED HEREIN, A LICENSED ENGINEER OR ARCHITECT SHALL PREPARE SITE SPECIFIC DOCUMENTS FOR USE WITH THIS DOCUMENT.

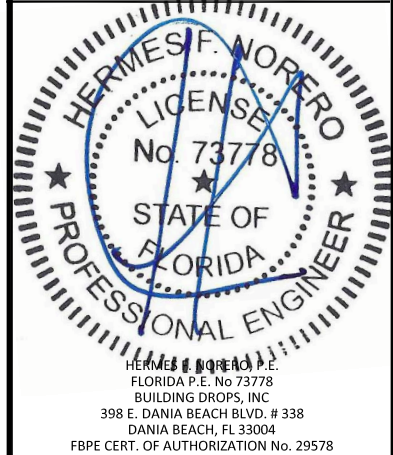

FL #:	FL27614
DATE:	04.19.19
DWG. BY:	EG
CHK. BY:	HFN
SCALE:	NTS
DWG. #:	ECI012
SHEET:	4

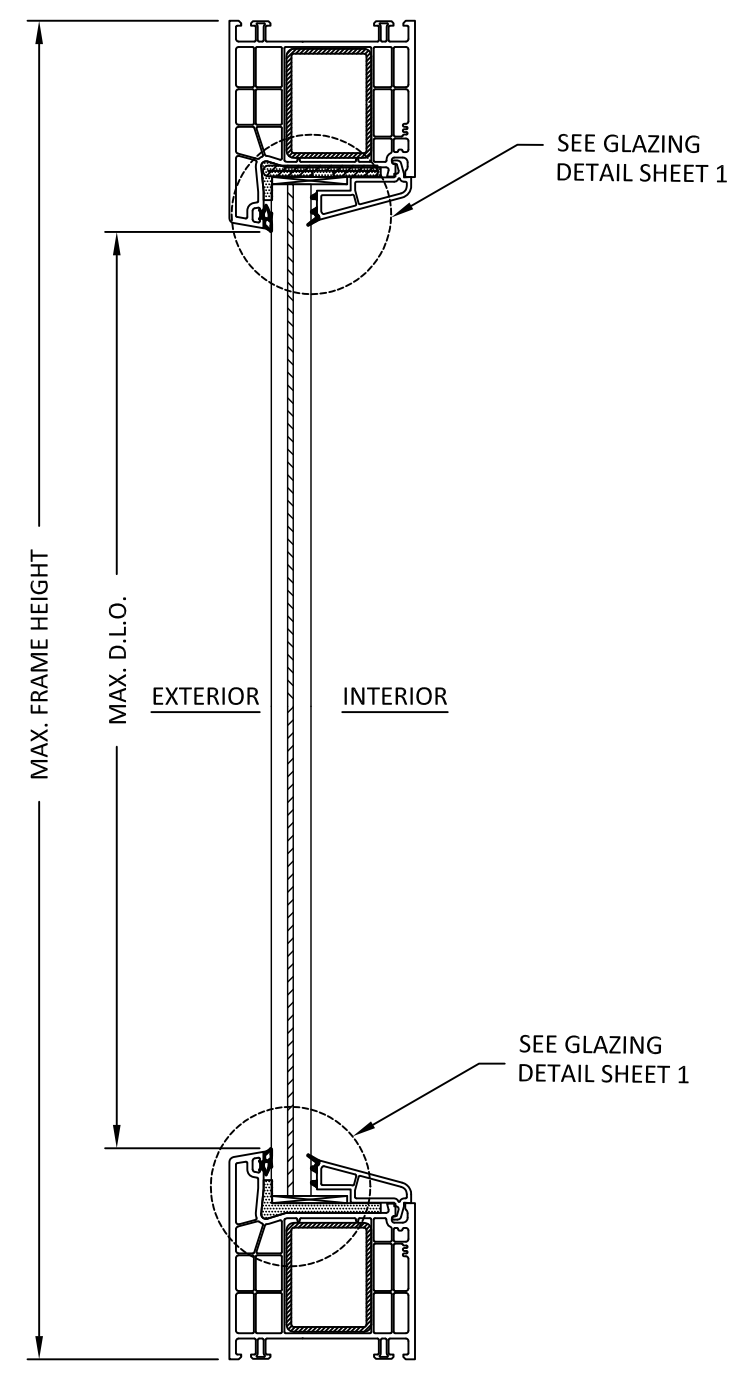

A
4 **VERTICAL SECTION**
FIXED WINDOW - TWIN

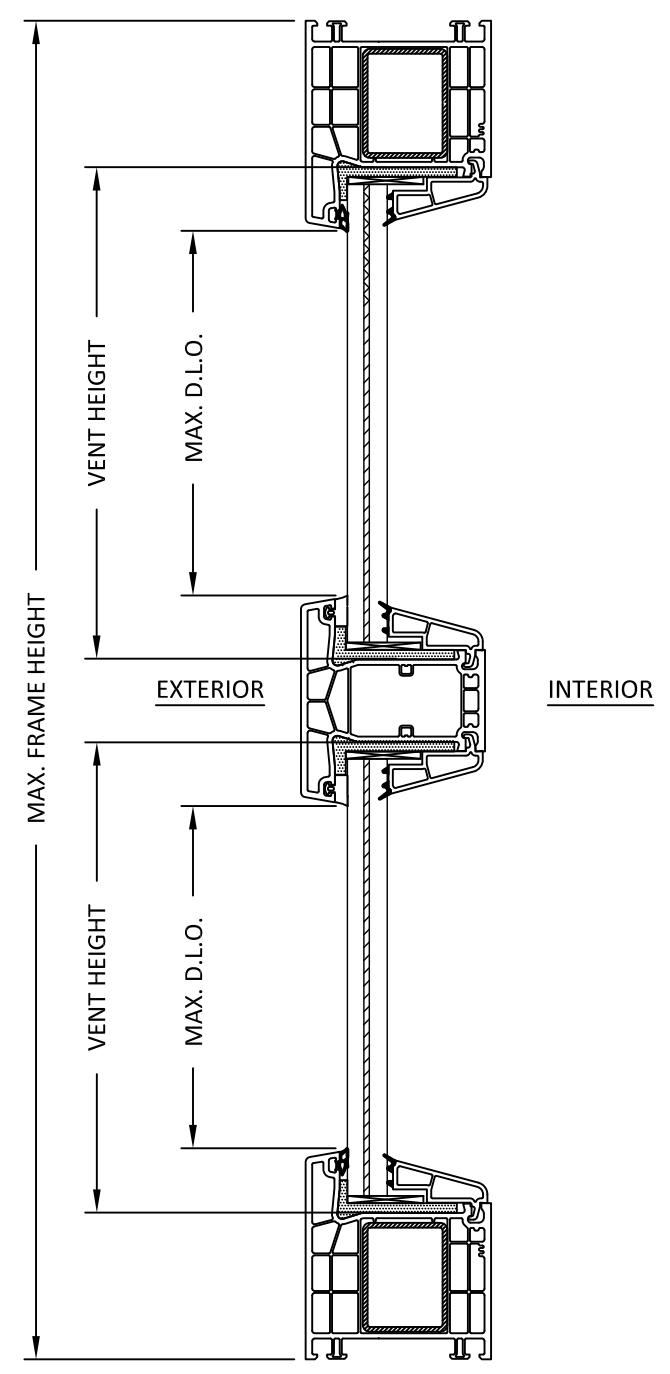

B
4 **VERTICAL SECTION**
FIXED WINDOW - TWIN

REPRESENTATIVE DETAILS SHOWN. MONOLITHIC AND INSULATING GLAZING ARE INTERCHANGEABLE



7905 NW 77TH AVE
MEDLEY, FL 33166
PH: (305) 888-5718 FX: (305) 220-5073

TITLE: 76AD FIXED WINDOW
(IMPACT) (HVHZ)
HORIZONTAL SECTIONS

PREPARED BY:  BUILDING DROPS, INC.
398 E. DANIA BEACH BLVD., STE. 338
DANIA BEACH, FL 33004
PH: (954) 399-8478
FAX: (954) 744-4738
WEB: www.buildingdrops.com

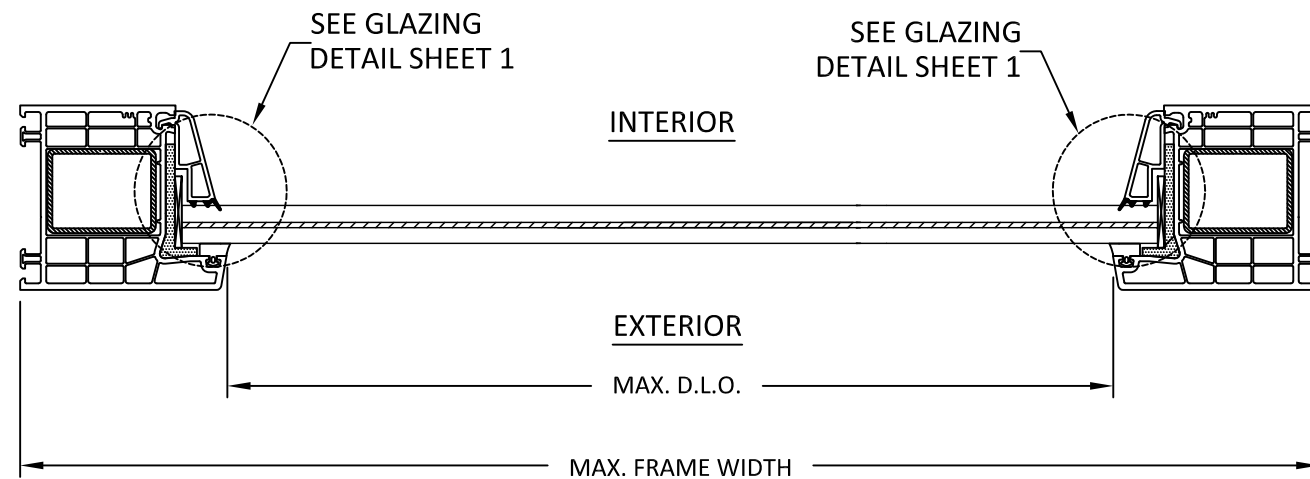

A HORIZONTAL SECTION
5 FIXED WINDOW - SINGLE

REPRESENTATIVE DETAILS SHOWN. MONOLITHIC AND INSULATING GLAZING ARE INTERCHANGEABLE

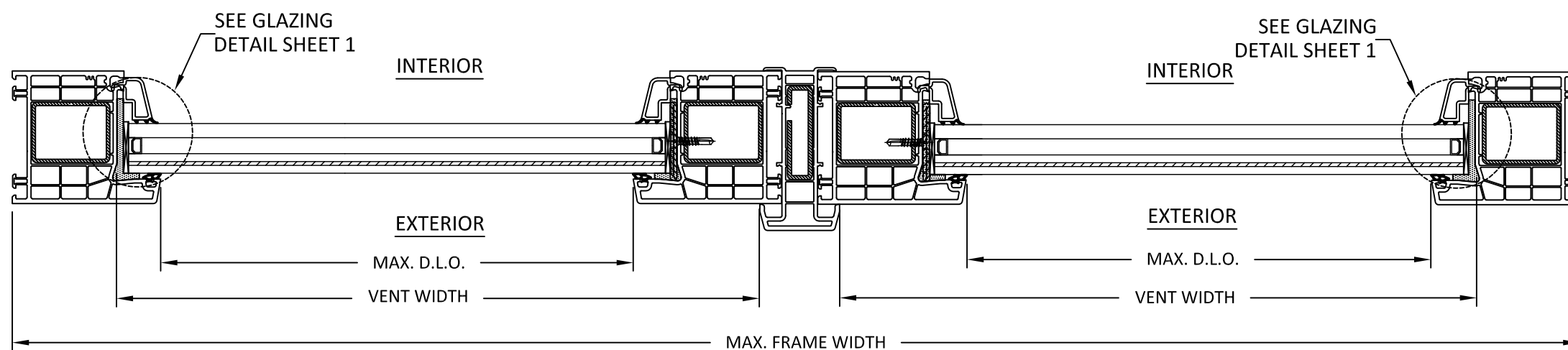

B HORIZONTAL SECTION
5 FIXED WINDOW - TWIN

THE INSTALLATION DETAILS DESCRIBED HEREIN ARE GENERIC AND MAY NOT REFLECT ACTUAL CONDITIONS FOR A SPECIFIC SITE. IF SITE CONDITIONS CAUSE INSTALLATION TO DEVIATE FROM THE REQUIREMENTS DETAILED HEREIN, A LICENSED ENGINEER OR ARCHITECT SHALL PREPARE SITE SPECIFIC DOCUMENTS FOR USE WITH THIS DOCUMENT

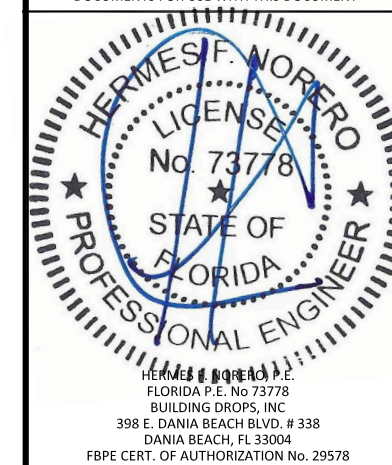

FL #:	FL27614	
DATE:	04.19.19	
DWG. BY:	EG	CHK. BY: HFN
SCALE:	NTS	
DWG. #:	ECI012	
SHEET:	5	

6/21/2019 5:24 PM

s:\projects\eurowcraft\industries\inc\fb-c-19-0320 - fbc submittal - fl2092, fl27614, fl27615 - revision\dwg\fixed\ect012 - fx.dwg



7905 NW 77TH AVE
MEDLEY, FL 33166
PH: (305) 888-5718 FX: (305) 220-5073

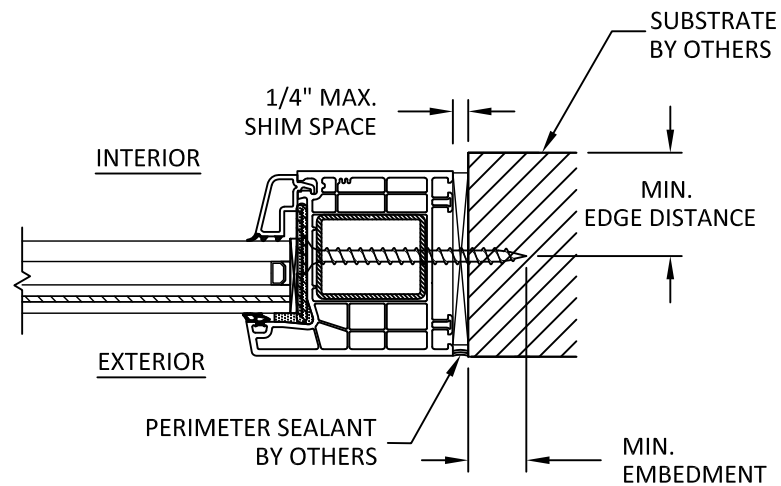

A
6 **HORIZONTAL SECTION**
THROUGH FRAME (JAMB)

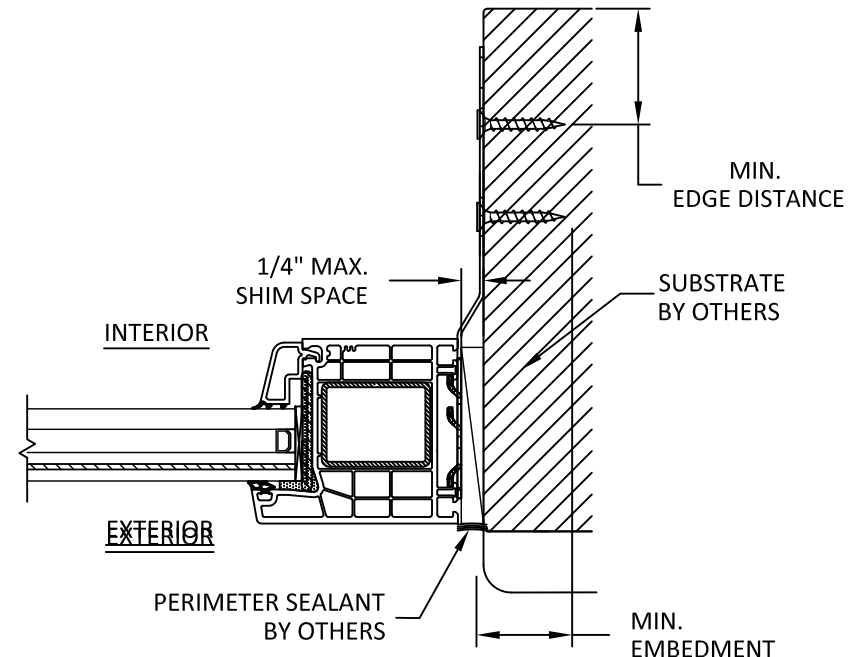

B
6 **HORIZONTAL SECTION**
STRAP (JAMB)

HEAD AND SILL SIMILAR

INSTALLATION NOTES:

- ONE (1) INSTALLATION ANCHOR IS REQUIRED AT EACH ANCHOR LOCATION SHOWN.
- THE NUMBER OF INSTALLATION ANCHORS DEPICTED IS THE MINIMUM NUMBER OF ANCHORS TO BE USED FOR PRODUCT INSTALLATION OF THE MAXIMUM SIZE LISTED.
- INSTALL INDIVIDUAL INSTALLATION ANCHORS WITHIN A TOLERANCE OF $\pm 1/4$ INCH THE DEPICTED LOCATION & SPACING IN THE ANCHOR LAYOUT DETAILS (I.E., WITHOUT CONSIDERATION OF TOLERANCES). TOLERANCES ARE NOT CUMULATIVE FROM ONE INSTALLATION ANCHOR TO THE NEXT.
- SHIM AS REQUIRED AT EACH INSTALLATION ANCHOR WITH LOAD BEARING SHIM(S). MAXIMUM ALLOWABLE SHIM STACK TO BE 1/4 INCH. SHIM WHERE SPACE OF 1/16 INCH OR GREATER OCCURS. SHIM(S) SHALL BE CONSTRUCTED OF HIGH DENSITY PLASTIC OR BETTER.
- FOR MASONRY OR CONCRETE OPENINGS, A 1X WOOD BUCK MAY BE USED (OPTIONAL) AS LONG AS THE MINIMUM EMBEDMENT AND EDGE DISTANCE REQUIREMENTS ARE STILL MET WITHIN THE CORRESPONDING HOST SUBSTRATE. SEE GENERAL NOTE #3 ON SHEET 1 FOR MORE INFORMATION.
- MINIMUM EMBEDMENT AND EDGE DISTANCE EXCLUDE WALL FINISHES, INCLUDING BUT NOT LIMITED TO STUCCO, FOAM, BRICK VENEER, AND SIDING.
- INSTALLATION ANCHORS AND ASSOCIATED HARDWARE MUST BE MADE OF CORROSION RESISTANT MATERIAL OR HAVE A CORROSION RESISTANT COATING.
- FOR HOLLOW BLOCK AND GROUT FILLED BLOCK, DO NOT INSTALL INSTALLATION ANCHORS INTO MORTAR JOINTS. EDGE DISTANCE IS MEASURED FROM FREE EDGE OF BLOCK OR EDGE OF MORTAR JOINT INTO FACE SHELL OF BLOCK.
- INSTALLATION ANCHORS SHALL BE INSTALLED IN ACCORDANCE WITH ANCHOR MANUFACTURER'S INSTALLATION INSTRUCTIONS, AND ANCHORS SHALL NOT BE USED IN SUBSTRATES WITH STRENGTHS LESS THAN THE MINIMUM STRENGTH SPECIFIED BY THE ANCHOR MANUFACTURER.

ANCHOR SCHEDULE				
METHOD	SUBSTRATE	ANCHOR SCHEDULE	MIN EMBEDMENT	MIN. EDGE DISTANCE
THROUGH FRAME	WOOD: MIN. SG = 0.55	#10 WOOD SCREW FLAT HEAD	1.5"	0.75"
	METAL: 18 GAUGE Steel, MIN. Fy = 33KSI	#10 TEK SCREW FLAT HEAD	3 THREADS MIN PENETRATION BEYOND METAL	0.5"
	CONCRETE: MIN. f'c=3000PSI	3/16" ITW TAPCON FLATHEAD	1.25"	2.0
	MASONRY: CMU per ASTM C90 MIN. 2000 PSI	3/16" ITW TAPCON FLATHEAD	1"	2.0

TITLE: 76AD FIXED WINDOW (IMPACT) (HVHZ)

INSTALLATION NOTES, & ANCHOR DETAILS

PREPARED BY: BUILDING DROPS, INC.

398 E. DANIA BEACH BLVD., STE. 338
DANIA BEACH, FL 33004
PH: (954)399-8478
FAX: (954)744-4738
WEB: www.buildingdrops.com



REMARKS	BY	DATE

THE INSTALLATION DETAILS DESCRIBED HEREIN ARE GENERIC AND MAY NOT REFLECT ACTUAL CONDITIONS FOR A SPECIFIC SITE. IF SITE CONDITIONS CAUSE INSTALLATION TO DEVIATE FROM THE REQUIREMENTS DETAILED HEREIN, A LICENSED ENGINEER OR ARCHITECT SHALL PREPARE SITE SPECIFIC DOCUMENTS FOR USE WITH THIS DOCUMENT



FL #: **FL27614**

DATE: **04.19.19**

DWG. BY: **EG** CHK. BY: **HFN**

SCALE: **NTS**

DWG. #: **ECI012**

SHEET: **6**

BILL OF MATERIALS

ITEM	PART No.	DESCRIPTION	MATERIAL
1	76102	FRAME - RIGID VINYL	VINYL
2	2454	I.G. GLAZING BEAD	VINYL
3	2452	MONO GLAZING BEAD	VINYL
4	-	GLAZING GASKET (RUBBER 70 DUR)	EPDM
5	V314	REINFORCEMENT	STEEL
6	V280	REINFORCEMENT	STEEL
7	V319	REINFORCEMENT	STEEL
8	V331	REINFORCEMENT	STEEL
9	76605	COUPLER MULLION TYPE I	VINYL
10	76302	MULLION TYPE II	STEEL

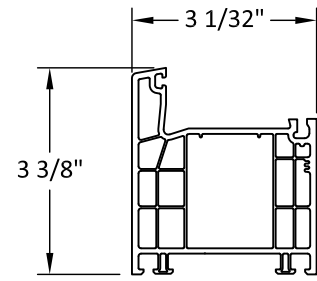

① FRAME

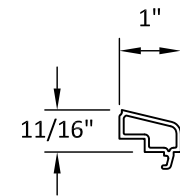

② I.G. GLAZING BEAD

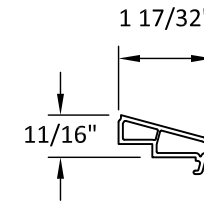

③ LAMI GLAZING BEAD

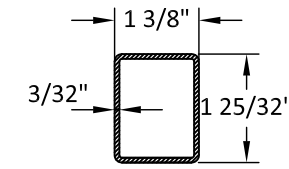

⑤ REINFORCEMENT

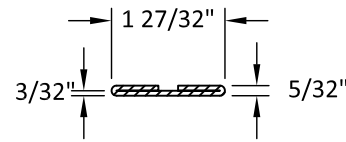

⑥ REINFORCEMENT

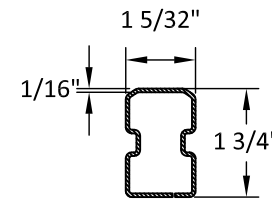

⑦ REINFORCEMENT

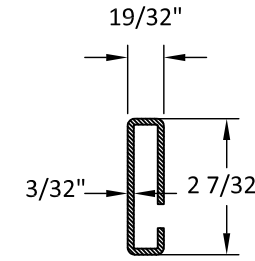

⑧ REINFORCEMENT

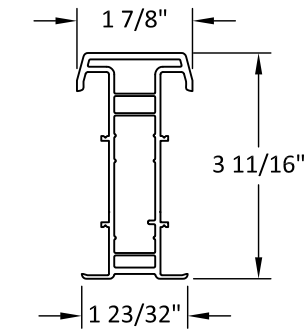

⑨ COUPLER MULLION - TYPE I

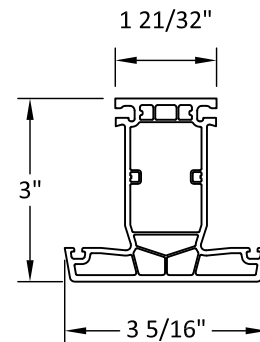

⑩ COUPLER MULLION - TYPE II

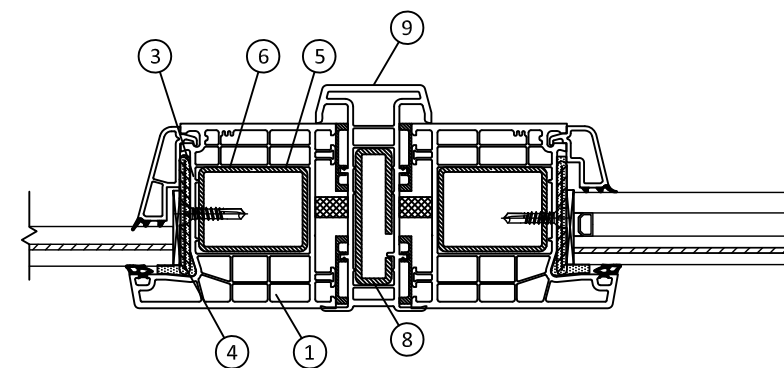
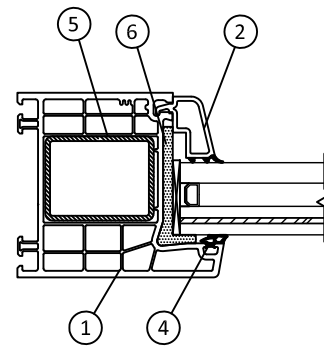
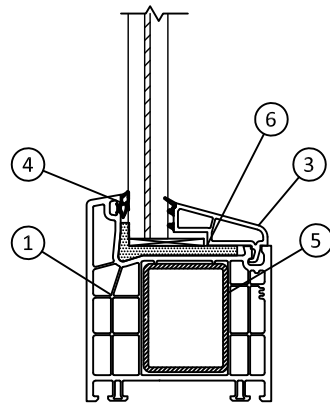
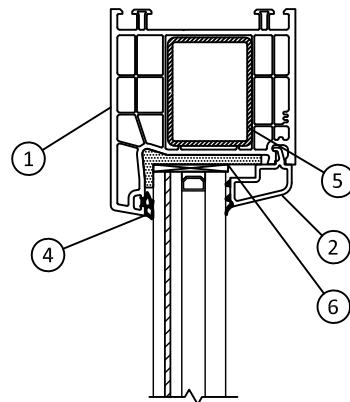

7905 NW 77TH AVE
MEDLEY, FL 33166
PH: (305) 888-5718 FX: (305) 220-5073

TITLE: 76AD FIXED WINDOW (IMPACT) (HVHZ)
COMPONENTS & BILL OF MATERIALS
PREPARED BY: BUILDING DROPS, INC.
398 E. DANIA BEACH BLVD., STE. 338
DANIA BEACH, FL 33004
PH: (954) 399-8478
FAX: (954) 744-4738
WEB: www.buildingdrops.com

REMARKS	BY	DATE

THE INSTALLATION DETAILS DESCRIBED HEREIN ARE GENERIC AND MAY NOT REFLECT ACTUAL CONDITIONS FOR A SPECIFIC SITE. IF SITE CONDITIONS CAUSE INSTALLATION TO DEVIATE FROM THE REQUIREMENTS DETAILED HEREIN, A LICENSED ENGINEER OR ARCHITECT SHALL PREPARE SITE SPECIFIC DOCUMENTS FOR USE WITH THIS DOCUMENT.

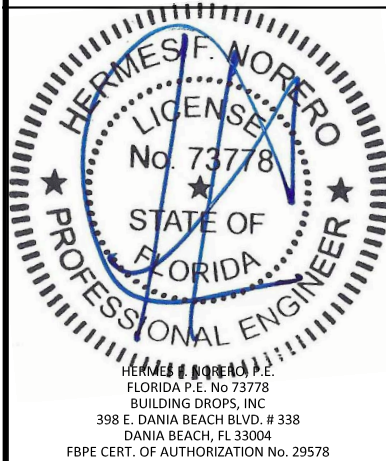

FL #: **FL27614**
DATE: **04.19.19**
DWG. BY: **EG** CHK. BY: **HFN**
SCALE: **NTS**
DWG. #: **ECI012**
SHEET:

s:\projects\eurowcraft\industries\inc\lbc-19-0320 - fbc submittal - fl2092, fl27614, fl27615 - revision\dwg\fixed\ect012 - fx.dwg 6/21/2019 5:24 PM